

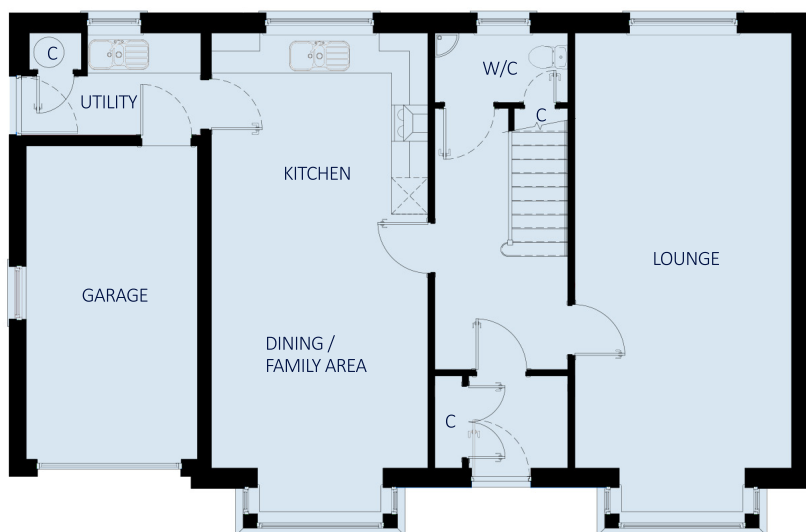

The

Blervie

Four bedroom detached house



GROUND FLOOR



FIRST FLOOR

The

Blervie

Four bedroom detached house with integral garage

This attractive and spacious four bedroom house features walk in bay windows to the lounge and family room, utility room, integral single garage, and ample built in storage in the bedrooms and throughout the rest of the house.

ROOM DIMENSIONS

Lounge	3570 x 7170	(11' 8" x 23' 6")
Kitchen / Dining / Family	3570 x 7170	(11' 8" x 23' 6")
Utility	2830 x 1680	(9' 3" x 5' 6")
WC	2195 x 1705	(7' 2" x 5' 7")
Bathroom	2585 x 2720	(8' 5" x 8' 11")
Master Bedroom	3110 x 3660	(10' 2" x 12' 0")
En-Suite	1590 x 3345	(5' 2" x 10' 11")
Bedroom 2	3585 x 2905	(11' 9" x 9' 6")
Bedroom 3	3265 x 2850	(10' 8" x 9' 4")
Bedroom 4	2925 x 2460	(9' 7" x 8' 0")
Garage	2830 x 5220	(9' 3" x 17' 1")

DESIGN OPTIONS

- > Sun lounge extension to rear
- > Separate family room
- > Separate shower enclosure to bathroom



Tulloch of Cummingston
 Tulloch House, Forsyth Street
 Hopeman IV30 5ST
T: 01343 835 600 **F:** 01343 835 700
www.tullochofcummingston.co.uk

All room sizes are approximate and may vary due to nature of construction. The above details do not form any part of a contract and are for illustration purposes only. Housetype illustrations are indicative, elevational treatments may vary dependant on development, location and specification.