



The

Birnie²

Two bedroom
semi- detached house

The Birnie²

Two bedroom semi-detached house

This two bedroom semi-detached house provides comfortable family accommodation over two levels offering a practical layout featuring a kitchen diner, open plan sun lounge, spacious lounge, built in wardrobes to both bedrooms and ample storage throughout.

DESIGN OPTIONS

- > Replace bath with shower in Bathroom

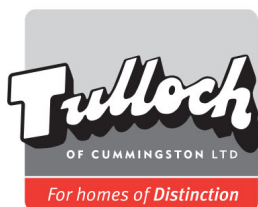

Tulloch of Cummingston

Tulloch House, Forsyth Street
Hopeman IV30 5ST

T: 01343 835 600 F: 01343 835 700

www.tullochofcummingston.co.uk

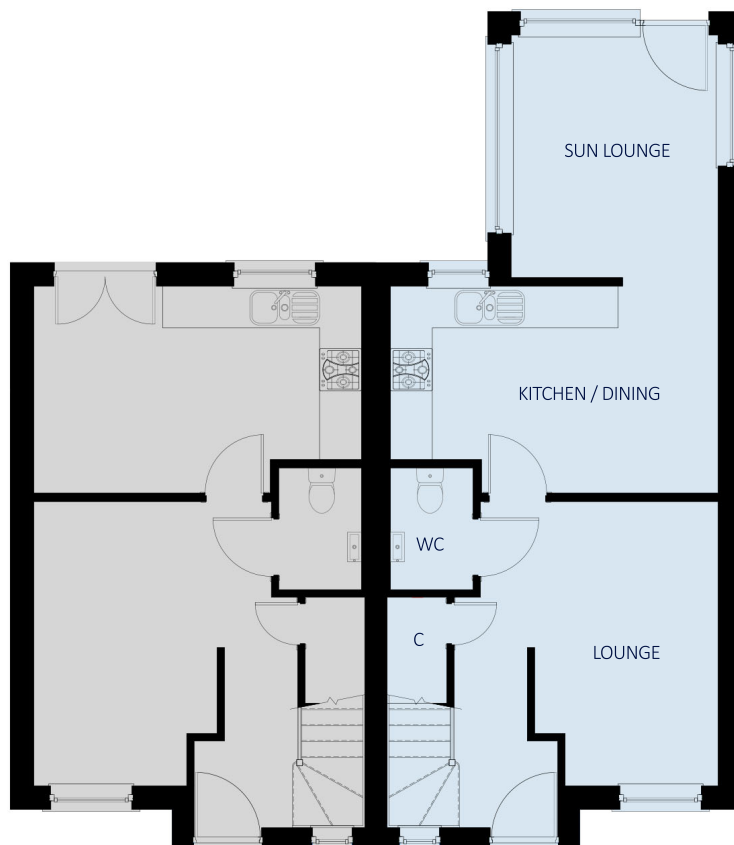

GROUND FLOOR

Lounge	2630 x 4080	(8' 8" x 13' 4")
Kitchen / Dining	4700 x 2970	(15' 5" x 9' 9")
WC	1185 x 1750	(3' 11" x 5' 9")
Sun Lounge	2970 x 2970	(9' 9" x 9' 9")

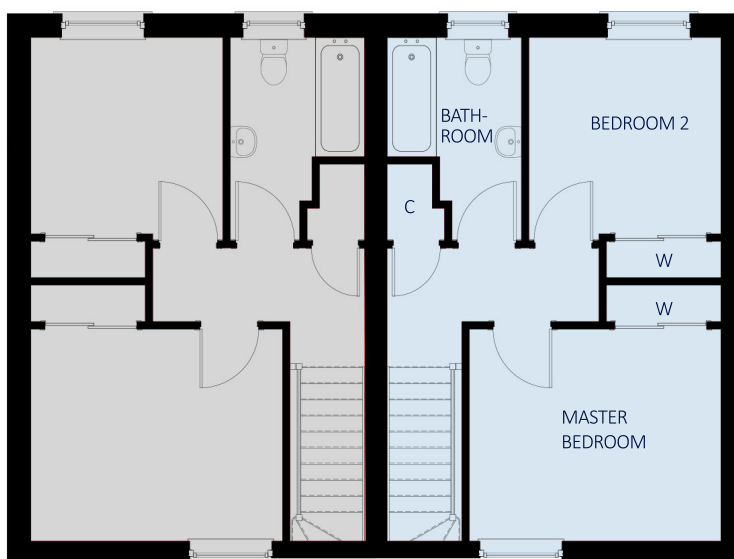

FIRST FLOOR

Master Bedroom	3580 x 3020	(11' 9" x 9' 11")
Bedroom 2	2735 x 2890	(8' 11" x 9' 6")
Bathroom	1910 x 2890	(6' 3" x 9' 6")

All room sizes are approximate and may vary due to nature of construction. The above details do not form any part of a contract and are for illustration purposes only. Housetype illustrations are indicative, elevational treatments may vary dependant on development, location and specification.